

MS-123

adjustable stand off
for balconies and stairs

MS-123 is an aluminum glass adapter to create balustrades on balconies and stairs which give the option to the installer to adjust the inclination of glass. It can be used for glasses with width up to 1500mm, mounted and screwed on concrete or in an adequate durable steel construction. It is designed for glasses with thickness from 10mm up to 25,8mm. In a glass with width from 1000mm to 1500mm 6 pcs of MS-123 must be used minimum and in a glass with width up to 1000mm 4 pcs of MS-123 must be used minimum arranged as shown in pic.1.

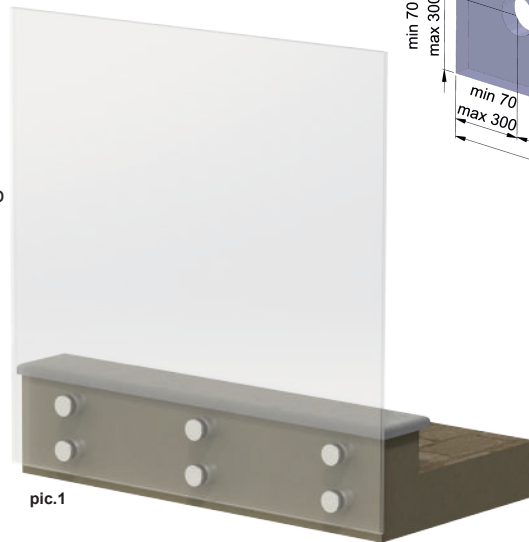

pic.1

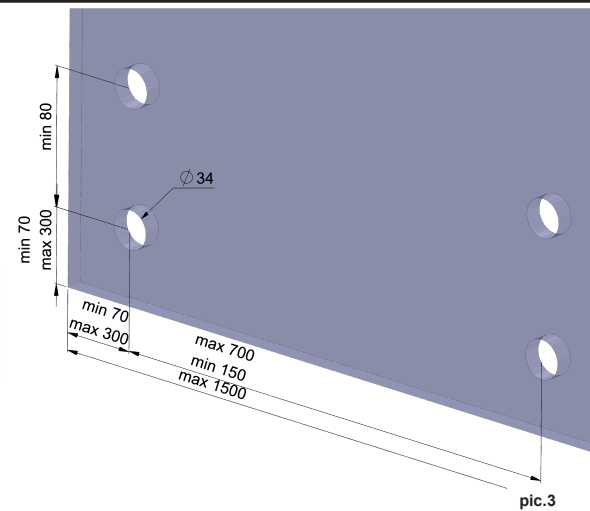

pic.3

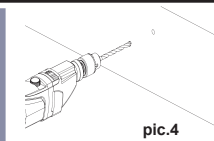

pic.4

Use a hammer drill with a hammer bit to open the holes with dimensions according to the size of the glass to be fit and in accordance with the fixation method that will be used.

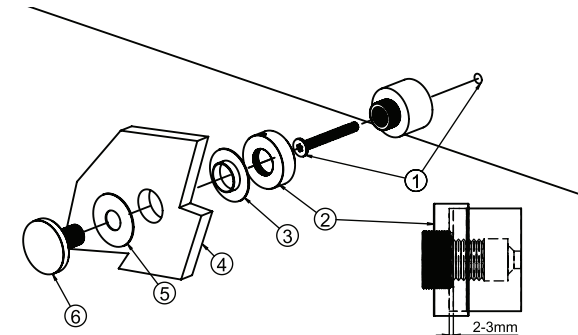

pic.5

Installation instructions and permitted dimensions

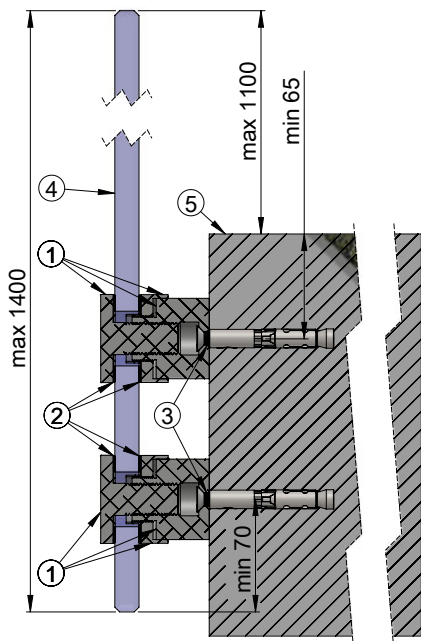

pic.2

1. MS-123
2. PA6 washers
3. Glass thickness 10mm up to 25,8mm.
4. Fixing with concrete screws
Fischer 8X90 40/25 SK
Hilti HUS-3 C8x85mm 35/25/15 or
Fischer high performance anchor FH II 12/M8
with M8x35mm countersunk screw or
any comparable anchor
5. Floor level

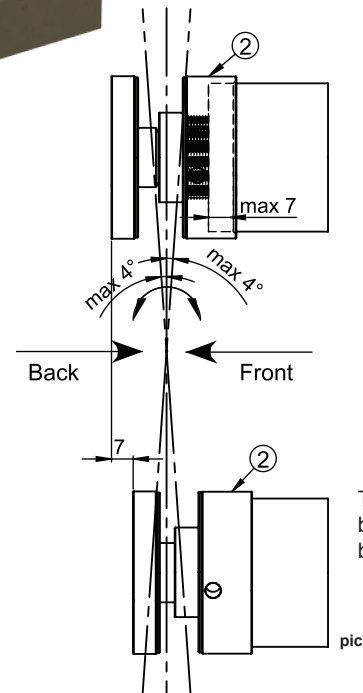

pic.6

1. Install the base part of the MS-123 with the fixation method that you have chosen.
2. Screw the adjustment nut of the MS-123 leaving a gap of 2-3mm between it and the base part.
3. Install the PA6 washer with the neck.
4. Add the glass.
5. Install the thin PA6 washer.
6. Install and tighten the front part of the MS-123.

Adjustment

The MS-123 gives the ability to the Installer to adjust the surface of the glass by moving it back or front max 7mm, or change the inclination max 4 degrees (pic.6), by screwing or unscrewing the adjustment nut (2).

PANIDIS S.A. is not responsible for the outcome of incorrect and ineffective positioning of the railing systems.